



**SUBMERSIBLE PUMPS & MOTORS
(50 HZ / 60 HZ)**

www.marwaanpumps.com

CHASING EXCELLENCE
AGRICULTURE ▪ INDUSTRIAL ▪ RESIDENTIAL



ADDRESS:
117, VIHAN SQUARE, ODE,
DASKROI, AHMEDABAD - 382425,
GUJARAT, INDIA

CALL US:
+91 94271 04110

EMAIL:
marwaanpumps@gmail.com
export@marwaanpumps.com
WEB: www.marwaanpumps.com

GSTN NO: 24ACDFM8689G1ZS

PAN NO: ACDFM8689G

8" WATER FILLED SUBMERSIBLE MOTOR

Marwaan submersible motors are water-lubricated, designed for installation in 8-inch diameter or larger water wells. These motors can be easily rewound & repaired. Marwaan submersible motors are robust, rewindable, and pre-filled with clean water and anti-corrosion fluid. The stator winding is of PVC or polypropylene insulated copper winding wires. It features water-lubricated radial and thrust bearings.

Dynamically balanced rotors of these Marwaan submersible motors maintain uniform clearance to give better efficiency and increase the life cycle of the water-lubricated bush bearings. Specially designed high-performance thrust bearings are used to withstand high axial thrust loads.

Pressure-equalizing rubber diaphragm is provided to guard against pressure and volume variations due to thermal expansion of water inside the motor. The motor is sealed by O-rings, shaft seals, and sand guards to prevent leakage of motor lubricant and ingress of well water, sand, and fibre particles into the motor. Mounting dimensions of motors are in accordance with the NEMA standard.



PRODUCT SPECIFICATION

- Rewindable
- Upper & Lower Housing, Connecting Piece and Motor Base: Graded CI Casting with CED or PU Paint
- Stator Shell : SS 304
- Motor Shaft : SS 431 / Shaft Extension SS 304
- Winding Wire : Polypropylene or PVC insulated
- Shaft Extension & Coupling Dimensions: As per NEMA Standards
- Degree of Protection : IP 68
- Max Permissible Temperature : 35°C (Ambient Temp: 45°C)
- Nos. of Starts per Hour : Max 20 at regular intervals
- Voltage Variation : +6%/-10% at rated voltage
- Bearing : Water-lubricated radial and thrust bearing (Carbon vs Chrome Steel)
- Max Depth Immersion : 500 metres
- Motor Cable Length : 5.0 metres (3 core/4 core)
- Maximum Outer Diameter : 192 mm
- Power Range : 7.5 kW – 110 kW
- Versions :
- A.C. Three-phase : 380 - 400 - 415 Volt / 50 Hz
: 230 - 380 - 460 Volt / 60 Hz
- Direct Online (DOL) : - 7.5kw - 75kW 4.0 kW - 45kW
- Star Delta (S.D.) : - 7.5kw - 110kW
- Type of Duty : S1 (Continuous)

PRODUCT FEATURES

- Marwaan Submersible Motors are robust, rewindable, and pre-filled with clean water mixed with anti-corrosion fluid
- Stator shell with corrosion-resistant Stainless Steel
- Bearing: Water-lubricated radial and thrust bearing
- Shaft extension made of Stainless Steel AISI 420
- High-efficiency electrical design for lower operating cost
- Pressure compensation diaphragm

PRODUCT APPLICATION

Marwaan prime mover submersible motors are suitable to couple with deep well submersible pumps used for:

- Residential Purpose
- Irrigation
- Fountains
- Industrial Water Supply
- Pressure Boosting Units
- Gardens & Horticulture
- Drip & Sprinkler Systems
- Mining Industries
- Oil & Gas Industries
- De-watering
- Fire Fighting



8" WATER FILLED SUBMERSIBLE MOTOR

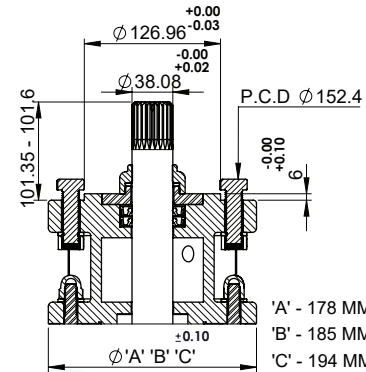

Sr. NO.	DESCRIPTION	QTY.
1	MOTOR BASE	1
2	BREATHER DIAPHRAGM	1
3	ROCKER SUPPORT	1
4	MOTOR BASE COVER	1
5	THRUST BEARING	1
6	LOWER BUSH HOUSING	1
7	LOWER CLAMPING STUD	4
8	CARBON BUSH	5
9	STATOR STAMPING	AS PER S.L.
10	END LAMINATION	2
11	STATOR TUBE	1
12	STUD RING	2
13	ROTOR	1
14	UPPER BUSH HOUSING	1
15	UPPER CLAMPING STUD	4
16	TEFLONE WASHER	1
17	MECHANICAL SEAL	1
18	MECHANICAL SEAL CAP	1
19	CONNECTING PIECE	1
20	OIL SEAL	2
21	OIL SEAL COVER	1
22	RUBBER SAND GAURD	1
23	HEX BOLT	4
24	THRUST PLATE COUNTER	1
25	INSULATED WINDING WIRE	

